

**LEGEND**

SITE BOUNDARY	
PROPOSED CARRIAGEWAY BITUMEN	
PROPOSED CARRIAGEWAY GATEWAY	
PROPOSED FOOTPATH (CONCRETE)	
PROPOSED TACTILE BLISTER BUFF	
PROPOSED BALCONY AND ELEVATED WALKWAY	
PROPOSED WALKWAY	
PROPOSED VERGE	
EXISTING WATERCOURSE	
PROTECTED STRUCTURE	
VIEW IDENTIFIED IN DRAFT COUNTY DEVELOPMENT PLAN	
LIGHT POLE	

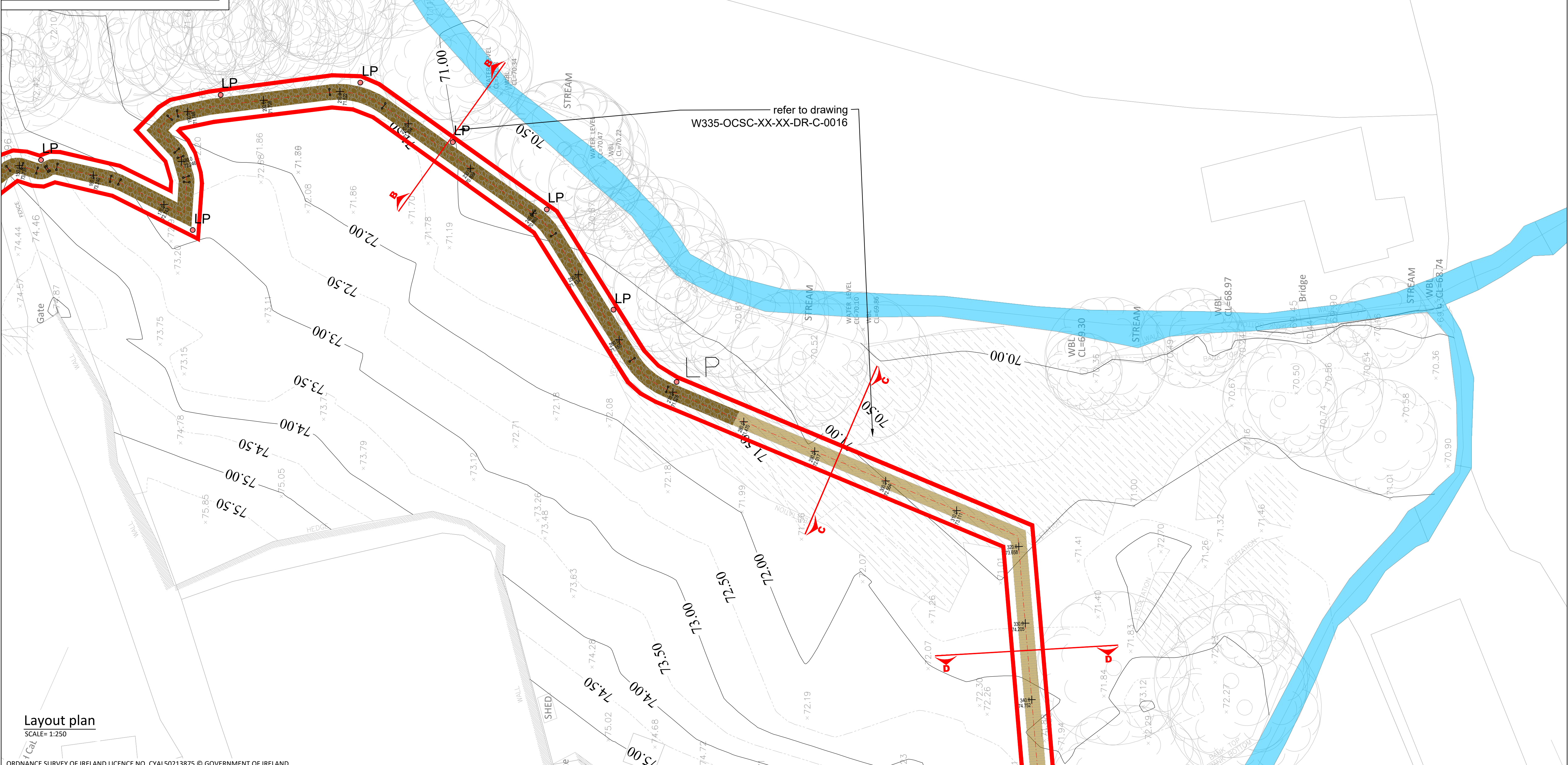
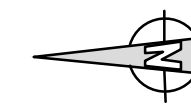

**Layout plan**  
SCALE= 1:250

ORDNANCE SURVEY OF IRELAND LICENCE NO. CYALS0213875 © GOVERNMENT OF IRELAND

- FOR SETTING OUT REFER TO ARCHITECT'S DRAWINGS.
- THIS DRAWING TO BE READ IN CONJUNCTION WITH ALL OTHER ARCHITECTURAL AND ENGINEERING DRAWINGS AND ALL OTHER RELEVANT DRAWINGS AND SPECIFICATIONS.
- DO NOT SCALE THIS DRAWING. USE FIGURED DIMENSIONS ONLY.
- NO PART OF THIS DOCUMENT MAY BE REPRODUCED OR TRANSMITTED IN ANY FORM OR STORED IN ANY RETRIEVAL SYSTEM OF ANY NATURE WITHOUT THE WRITTEN PERMISSION OF O'CONNOR SUTTON CRONIN AS COPYRIGHT HOLDER EXCEPT AS AGREED FOR USE ON THE PROJECT FOR WHICH THE DOCUMENT WAS ORIGINALLY ISSUED.

Rev No.	Date	Revision Note	Drn by	Chkd by
P01	20.05.22	FIRST ISSUE	RF	NMcM

Rev No.	Date	Revision Note	Drn by	Chkd by



Head Office,  
9 Prussia Street,  
Dublin 7,  
D07 KT57

TEL +353 (0)1 8682000  
e: [contactus@ocsc.ie](mailto:contactus@ocsc.ie)  
w: [www.ocsc.ie](http://www.ocsc.ie)



Client: Wicklow County Council  
Project: Newtownmountkennedy Riverside Walk

Title: S177 - Riverside Walk  
Site Layout Plan  
Sheet 02 of 03

Code | Originator | Zone | Level | Type | Role | Number | Status | Revision  
W335-OCSC-XX-XX-DR-C-0014 S2 P01  
Date: 20.05.22 Scale: 1:250 @ A1 Drn by:RF Chkd by:NMcMPrvd by:BO'R