

S:\MGC0712 - NDFA SHB3\MGC0712-02 - Blessington\8.0 Drawings\DA01 - Watermain Layout\SHB3-BLN-CS-RPS-DR-DA001 - WATERMAIN LAYOUT S4 P01.dwg

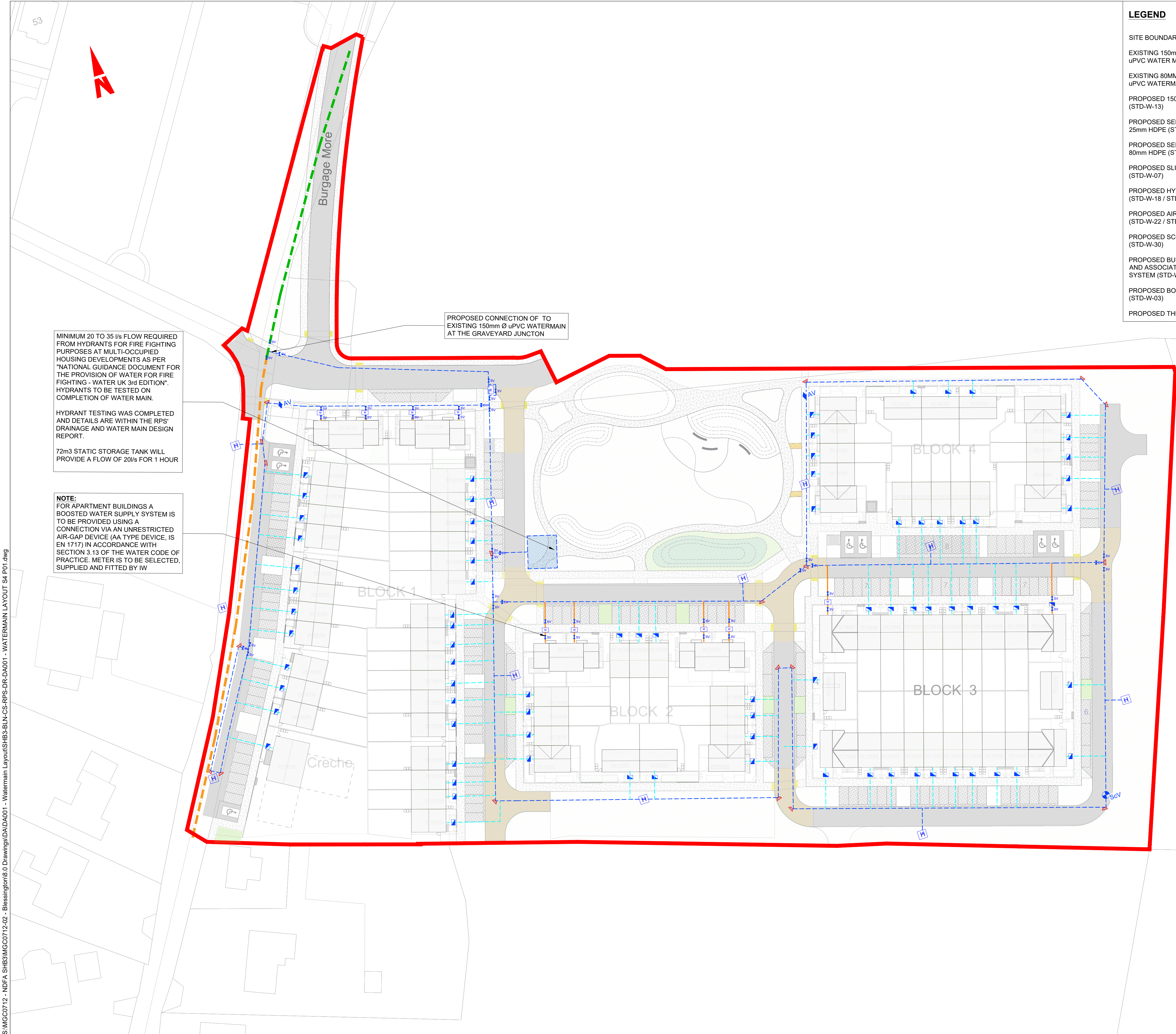

MINIMUM 20 TO 35 l/s FLOW REQUIRED FROM HYDRANTS FOR FIRE FIGHTING PURPOSES AT MULTI-OCCUPIED HOUSING DEVELOPMENTS AS PER "NATIONAL GUIDANCE DOCUMENT FOR THE PROVISION OF WATER FOR FIRE FIGHTING - WATER UK 3rd EDITION". HYDRANTS TO BE TESTED ON COMPLETION OF WATER MAIN.

HYDRANT TESTING WAS COMPLETED AND DETAILS ARE WITHIN THE RPS DRAINAGE AND WATER MAIN DESIGN REPORT.

72m³ STATIC STORAGE TANK WILL PROVIDE A FLOW OF 20l/s FOR 1 HOUR

NOTE:
FOR APARTMENT BUILDINGS A BOOSTED WATER SUPPLY SYSTEM IS TO BE PROVIDED USING A CONNECTION VIA AN UNRESTRICTED AIR-GAP DEVICE (AA TYPE DEVICE, IS EN 1717) IN ACCORDANCE WITH SECTION 3.13 OF THE WATER CODE OF PRACTICE. METER IS TO BE SELECTED, SUPPLIED AND FITTED BY IW

PROPOSED CONNECTION OF TO EXISTING 150mm Ø uPVC WATERMAIN AT THE GRAVEYARD JUNCTION

LEGEND

- SITE BOUNDARY
- EXISTING 150mm uPVC WATER MAIN
- EXISTING 80MM uPVC WATERMAIN
- PROPOSED 150mm WATERMAIN (STD-W-13)
- PROPOSED SERVICE CONNECTION 25mm HDPE (STD-W-03)
- PROPOSED SERVICE CONNECTION 80mm HDPE (STD-W-03)
- PROPOSED SLUICE VALVE (STD-W-07)
- PROPOSED HYDRANT (STD-W-18 / STD-W-19)
- PROPOSED AIR VALVE (STD-W-22 / STD-W-23)
- PROPOSED SCOUR VALVE (STD-W-30)
- PROPOSED BULK FLOW METER AND ASSOCIATED TELEMTRY SYSTEM (STD-W-26 / STD-W-26A)
- PROPOSED BOUNDARY BOX (STD-W-03)
- PROPOSED THRUST BLOCK

- General Notes:
- (i) Hard copies, dwf and pdf will form a controlled issue of the drawing. All other formats (dwg etc.) are deemed to be an uncontrolled issue and any work carried out based on these files is at the recipients own risk. RPS will not accept any responsibility for any errors from the use of these files, either by human error by the recipient, listing of the un-dimensioned measurements, compatibility with the recipients software, and any errors arising when these files are used to aid the recipients drawing production, or setting out on site. DO NOT SCALE, use figured dimensions only.
- (iii) This drawing is the property of RPS, it is a project confidential classified document. It must not be copied used or its contents divulged without prior written consent. The needs and expectations of client and RPS must be considered when working with this drawing.
- (iv) Information including topographical survey, geotechnical investigation and utility detail used in the design have been provided by others.
- (v) All Levels refer to Ordnance Survey Datum, Malin Head.
- Foul Sewer Notes:
1. All foul sewer works shall be carried out in accordance with Irish Water Standard Details and Code of Practice for Wastewater Infrastructure Document CDS-5030-03.
2. All pipe materials shall comply with Section 3.13 of the Irish Water Code of Practice for Wastewater Infrastructure Document CDS-5030-03.
3. Foul sewer service connections and inspection chambers to each dwelling shall be in accordance with Irish Water standard detail STD-WW-02.
4. All manhole chambers shall be in accordance with Irish Water standard detail STD-WW-10.
5. Trench backfill and bedding shall be in accordance with Irish Water standard detail STD-WW-07.
6. Concrete bed, haunch and surround shall be in accordance with Irish Water standard detail STD-WW-08.
4. Separation distances from other services, boundary walls etc. shall be in accordance with Irish Water standard detail STD-WW-05.
5. Separation distances from trees, shrubs etc. shall be in accordance with Irish Water standard detail STD-WW-06 & 06A.

- Storm Sewer Notes:
1. All pipe materials shall comply with Section 3.13 of the Irish Water Code of Practice for Wastewater Infrastructure Document CDS-5030-03.
2. All manhole chambers shall be in accordance with Irish Water standard detail STD-WW-10.
3. Trench backfill and bedding shall be in accordance with Irish Water standard detail STD-WW-07.
4. Concrete bed, haunch and surround shall be in accordance with Irish Water standard detail STD-WW-08.
- Watermain Notes:
1. All watermain works shall be carried out in accordance with Irish Water Standard Details and Code of Practice for Water Infrastructure Document CDS-5020-03.
2. All pipe materials shall be in compliance with Section 3.9 of Irish Water Code of Practice Document-CDS-5020-03.
3. Individual water service connections and boundary boxes to each dwelling shall be in compliance with Irish Water standard detail STD-W-02.
4. Separation distances from other services, boundary walls etc. shall be in accordance with Irish Water standard detail STD-W-11.
5. Separation distances from trees, shrubs etc. shall be in accordance with Irish Water standard detail STD-W-12 & 12A.
6. On line and off-line air valve details shall be in accordance with Irish Water standard detail STD-W-22 & STD-W-23 respectively.
7. Sluice valve details shall be in accordance with Irish Water standard detail STD-W-15.
8. On line and off-line hydrant details shall be in accordance with Irish Water standard detail STD-W-18 & STD-W-19 respectively.
9. Scour valve and chamber details shall be in accordance with Irish Water standard detail STD-W-30.

P04	12.11.21	CS	PM03	ISSUE FOR PLANNING	D*
P03	13.08.21	DM	MGR	ISSUE FOR REVIEW	D*
P02	23.07.21	DM	OK	ISSUE FOR INFORMATION	D*
P01	16.04.21	DM	PM03	ISSUE FOR INFORMATION	D*
Rev	Date	Chk	App	Amendment / Issue	App

Client

WICKLOW
ENDLESS OPPORTUNITIES

 **rps** MAKING COMPLEX EASY

Lyrr 2, IDA Business & Technology Park, Mervue, Galway
T +353 91 400200
W www.rpsgroup.com/ireland
E ireland@rpsgroup.com

Project	SHB 3 BLESSINGTON, CO. WICKLOW		
Title	WATERMAIN LAYOUT		
Model File Identifier	SHB3-BLN-CS-RPS-DR-DA001		
File Identifier	SHB3-BLN-CS-RPS-DR-DA001-01		
Created on	JULY 2021	Sheets	01 OF 01
Scale	1:500 @ A1 1:1000 @ A3	Status	S4
		Rev	P04