

File name: \\EU\AECOM\NET\COM\EMIA\K\IE\B\2\JOBS\PR-447455_BLESSINGTON_GREENWAY\900_CAD_GIS\910_CAD\20-SHEETS\VALLEYMOUNT\60617025_SHT_BLGWY_300_1_VALLEYMOUNT.DWG
 Last saved by: MCGOVERNT14 Last Plotted: 2023-12-14
 Project Management Initials: Designer: CL Checked: MC Approved: EOM ISO A1 594mm x 841mm

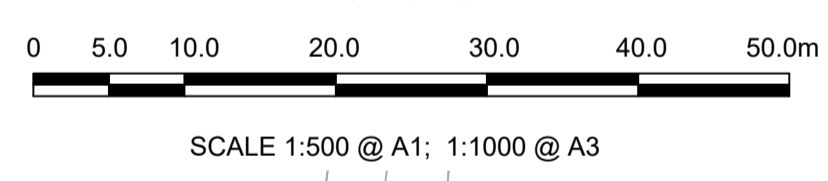

CROSS SECTION A
 SCALE: H 1:200, V 1:200. DATUM: 183.000

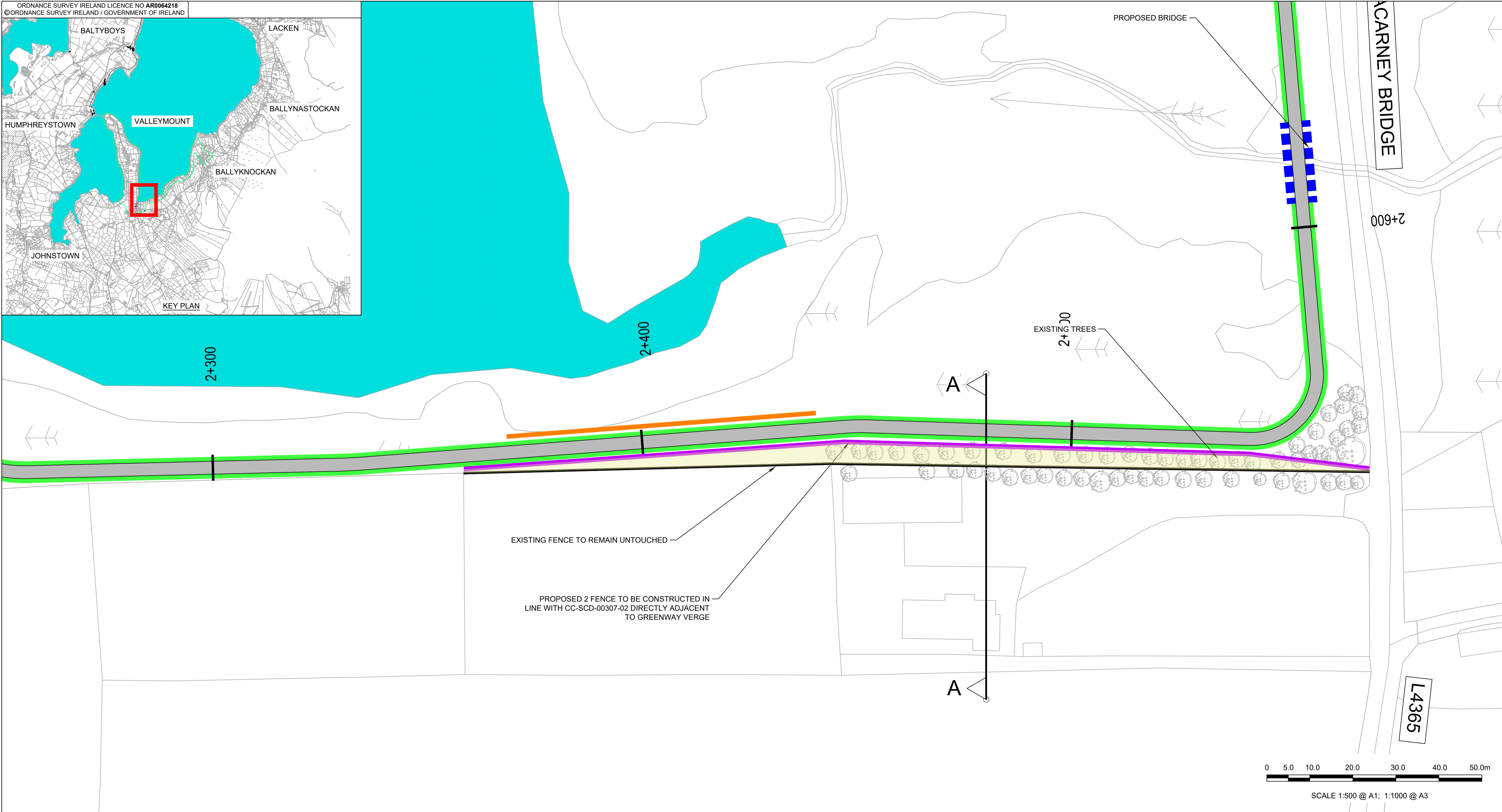
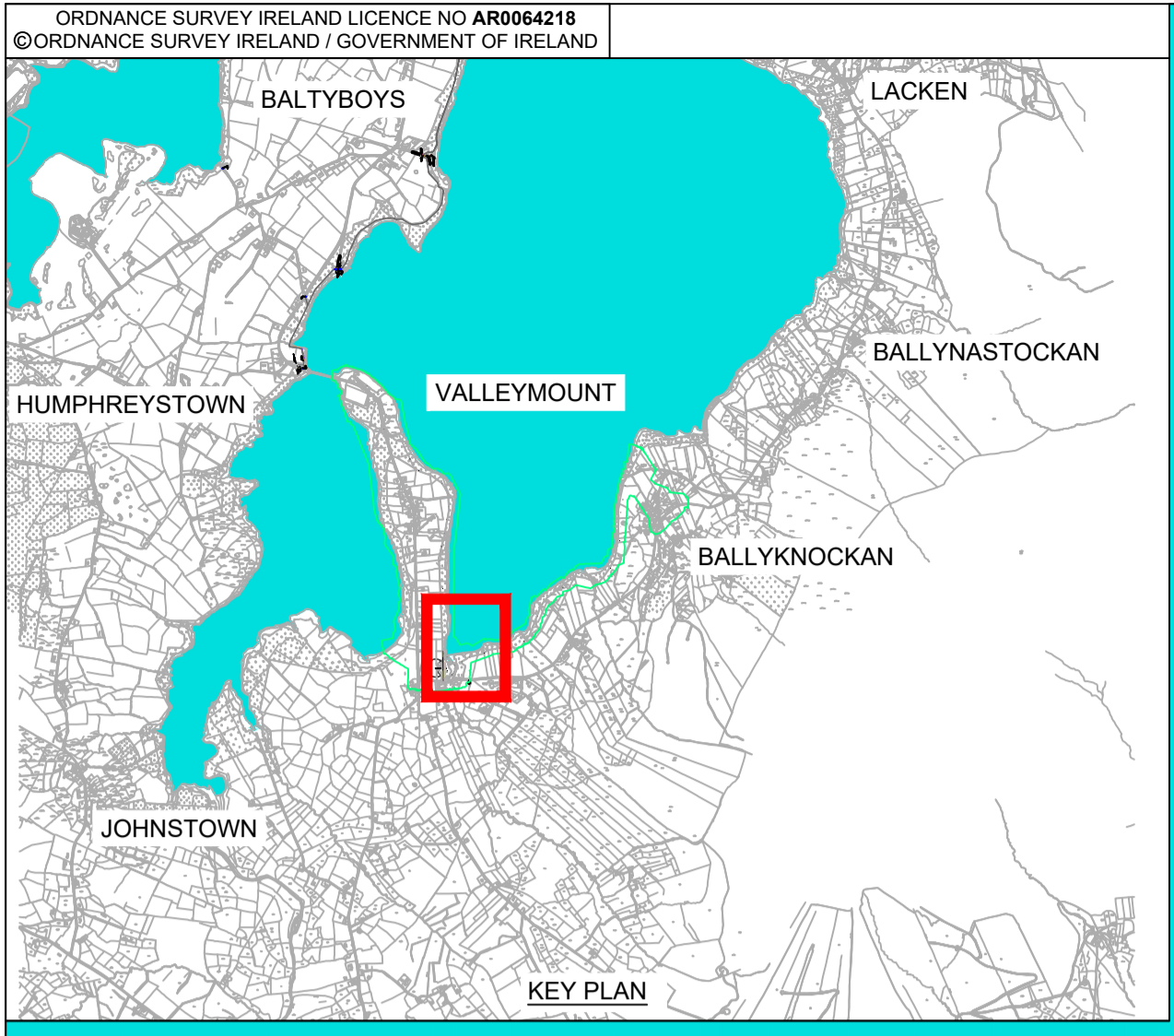
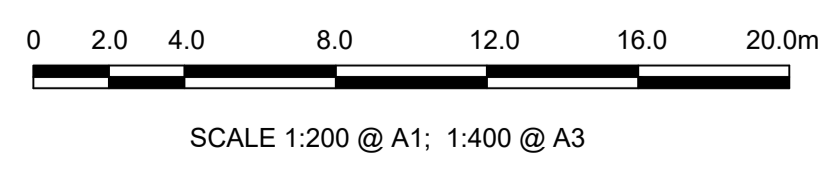
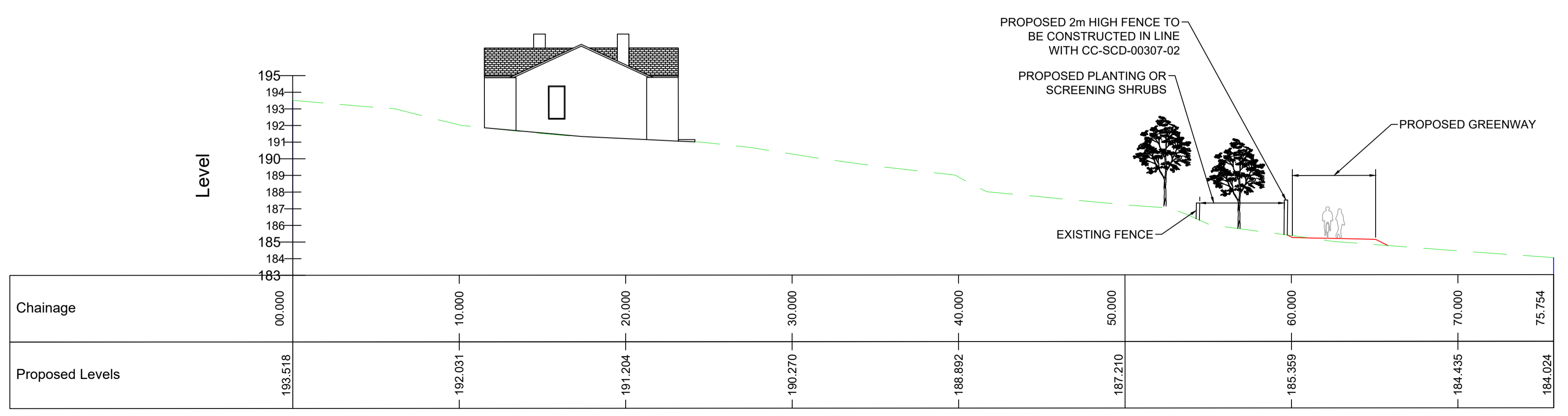

PROJECT
 BLESSINGTON
 eGREENWAY



CONSULTANT
 AECOM
 DOUGLAS BUSINESS CENTRE
 CARRIGALINE ROAD
 DOUGLAS
 CORK
 Tel: +353 (0)21 436 5006
 www.aecom.com

NOTES
 1. THIS DRAWING IS TO BE READ IN CONJUNCTION WITH ALL OTHER RELEVANT PLANNING DRAWINGS AND DOCUMENTS.

KEY:

	PROPOSED GREENWAY
	PROPOSED GRASS VERGE
	WATER CROSSING STRUCTURE
	BLESSINGTON LAKE
	PROPOSED FENCE LINE
	PROPOSED RETAINING WALL
	PROPOSED PLANTING OR SCREENING SCRUBS

ISSUE/REVISION

I/R	DATE	DESCRIPTION
A	DEC 2023	ISSUED FOR INFORMATION

PROJECT NUMBER
 60617025

SHEET TITLE
 BOUNDARY TREATMENT
 VALLEYMOUNT

SHEET NUMBER
 60617025_SHT_DD_BLGWY_300.1

This drawing has been prepared for the use of AECOM's client. It may not be used, modified, reproduced or relied upon by third parties, except as agreed by AECOM or as required by law. AECOM accepts no responsibility and denies any liability, whatsoever, to any party that uses or relies on this drawing without AECOM's express written consent. Do not scale this document. All measurements must be obtained from the stated dimensions.