

727733.367mE 703750.178mN

728023.208mE 703750.178mN



Chief Executive

fev

Kevin P
Nominated Officer

se 2/23/21

*marked of vesting
carry council*

Licence No.
2021/35/CCMA/WicklowCountyCouncil

PRAI Reference
S2021LR005515A.

Vesting Map

Map showing Vesting Area
to be granted to : Wicklow County Council

Land referred to is contained in Plot80b
(WCC CPO Order No.2 1999)
located in Timmore Td

Vesting Area outlined by Red Line and Shaded
Grey
Area of land to be Vested 0.0155Ha (0.0383 acre)

This map is computer
generated from O.S. digital files
plotted in accordance with
with Land Registry Regulations.
L.R. Map 1,2,2a,&3 Appendix B3

Wicklow O.S. Plans:3848-C,3848-A,
3847-D,3847-B

NO	INLS	DATE	DESCRIPTION

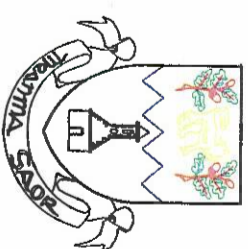

**WICKLOW
COUNTY
COUNCIL**

JOB :
N11 NEWTOWN TO BALLYNABARNY
ROAD IMPROVEMENT SCHEME

TITLE :
LAND VESTING MAP PLOT 80b

SCALE:	Drawn	Checked
HORIZ = 1:1000		
VERT =	Date:	Mar. 2021

DRAWING NO:
N11/NBRIS/LVM Plot80b

727733.367mE 703493.178mN

727733.367mE 703750.178mN

728023.208mE 703750.178mN

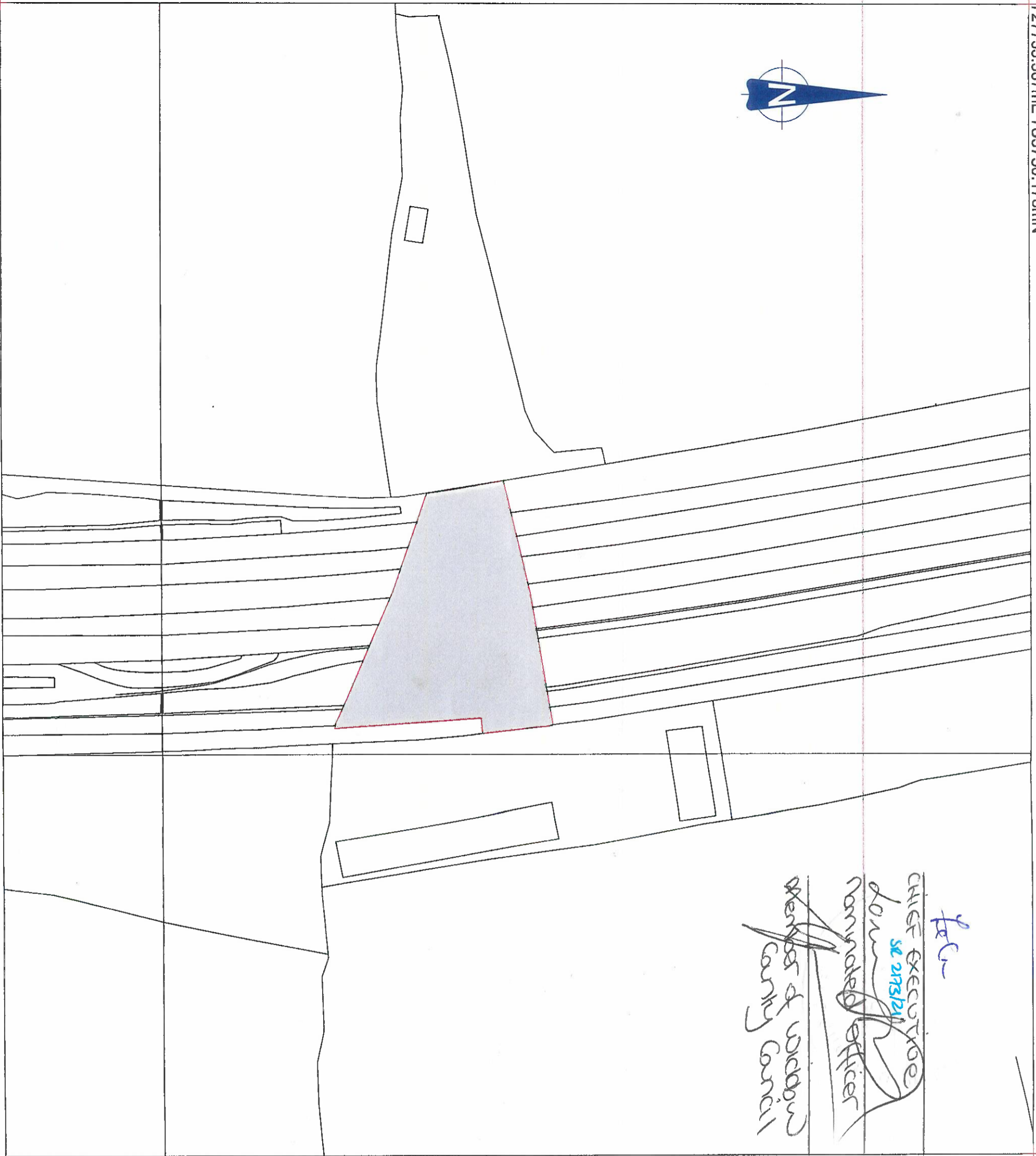

fecl
CHIEF EXECUTIVE
SE 21/3/21
deputy
Nominated officer
Members of Wicklow
County Council

Licence No.
2021/35/CCMA/WicklowCountyCouncil

PRAI Reference
S2021LR005516B.

Vesting Map

Map showing Vesting Area
to be granted to : Wicklow County Council

Land referred to is contained in Plot81a
(WCC CPO Order No.2 1999)
located in Timmore Td

Vesting Area outlined by Red Line and Shaded
Grey
Area of land to be Vested 0.2206Ha (0.5452 acre)

This map is computer
generated from O.S. digital files
plotted in accordance with
with Land Registry Regulations.
L.R. Map 1,2,2a, &3 Appendix B3
Wicklow O.S. Plans:3848-C,3848-A,
3847-D,3847-B

NO	INLS	DATE	DESCRIPTION

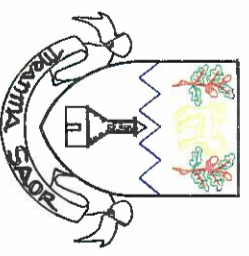

**WICKLOW
COUNTY
COUNCIL**

JOB :
N11 NEWTOWN TO BALLYNABARNY
ROAD IMPROVEMENT SCHEME

TITLE :
LAND VESTING MAP PLOT 81a

SCALE:	Drawn	Checked
HORIZ = 1:1000	Date:	Mar. 2021
VERT =		

DRAWING NO.:
N11/NBRIS/LVM Plot81a(1)

727733.367mE 703493.178mN

727733.367mE 703750.178mN

728023.208mE 703750.178mN

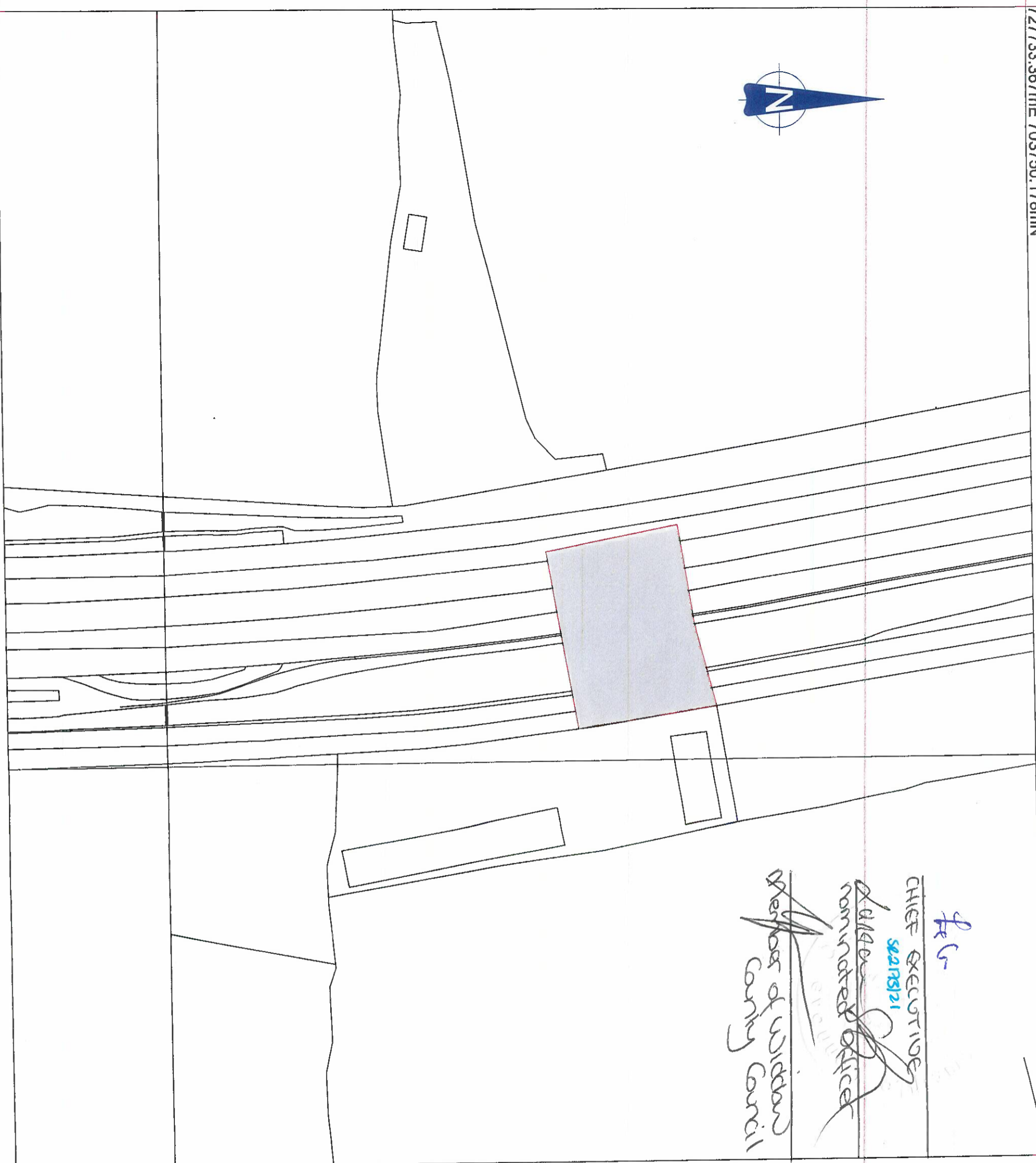

FC

CHIEF EXECUTIVE

521R121

Deputy Mayor
nominated officer

Mayor of Wicklow
County Council

Licence No.

2021/35/CCMA/WicklowCountyCouncil

PRAI Reference

S2021LR005517C.

Vesting Map

Map showing Vesting Area to be granted to : Wicklow County Council

Land referred to is contained in Plot81a (WCC CPO Order No.2 1999) located in Timmore Td

Vesting Area outlined by Red Line and Shaded Grey
Area of land to be Vested 0.1561Ha (0.3857 acre)

This map is computer generated from O.S. digital files plotted in accordance with with Land Registry Regulations.

L.R. Map 1,2,2a,83 Appendix B3

Wicklow O.S. Plans:3848-C,3848-A, 3847-D,3847-B

NO	INLS	DATE	DESCRIPTION

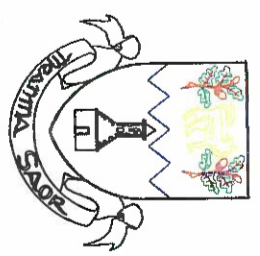

WICKLOW COUNTY COUNCIL

JOB : N11 NEWTOWN TO BALLYNABARNY ROAD IMPROVEMENT SCHEME

TITLE : LAND VESTING MAP PLOT 81a

SCALE:	Drawn	Checked
HORIZ = 1:1000	Date:	Mar. 2021
VERT =		

DRAWING NO: **N11/NBRIS/LVM Plot81a(2)**

727733.367mE 703493.178mN

727733.367mE 703750.178mN

728023.208mE 703750.178mN



fec
 CHIEF EXECUTIVE
SA 21/23/12
 PLANNING OFFICE
 Wicklow County Council

Licence No.
 2021/35/CCMA/WicklowCountyCouncil

PRAI Reference
S2021LR004999K.

Vesting Map

Map showing Vesting Area
 to be granted to : Wicklow County Council

Land referred to is contained in Plot80a
 (WCC CPO Order No.2 1999)
 located in Timmore TD

Vesting Area outlined by Red Line and Shaded
 Grey
 Area of land to be Vested 0.0215Ha (0.0530 acre)

This map is computer
 generated from O.S. digital files
 plotted in accordance with
 with Land Registry Regulations.
 L.R. Map 1.2,2a,&3 Appendix B3

Wicklow O.S. Plans:3848-C,3848-A,
 3847-D,3847-B

NO	INLS	DATE	DESCRIPTION

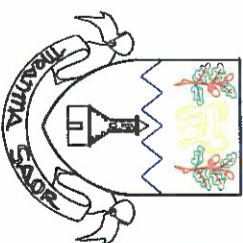

**WICKLOW
 COUNTY
 COUNCIL**

JOB :
 N11 NEWTOWN TO BALLYNABARNY
 ROAD IMPROVEMENT SCHEME

TITLE :
 LAND VESTING MAP PLOT 80a

SCALE:	Drawn	Checked
HORIZ = 1:1000	Date:	Mar. 2021
VERT =		

DRAWING NO:
N11/NBRIS/LVM Plot80a

727733.367mE 703493.178mN

727754.046mE 702553.035mN

728043.887mE 702553.035mN

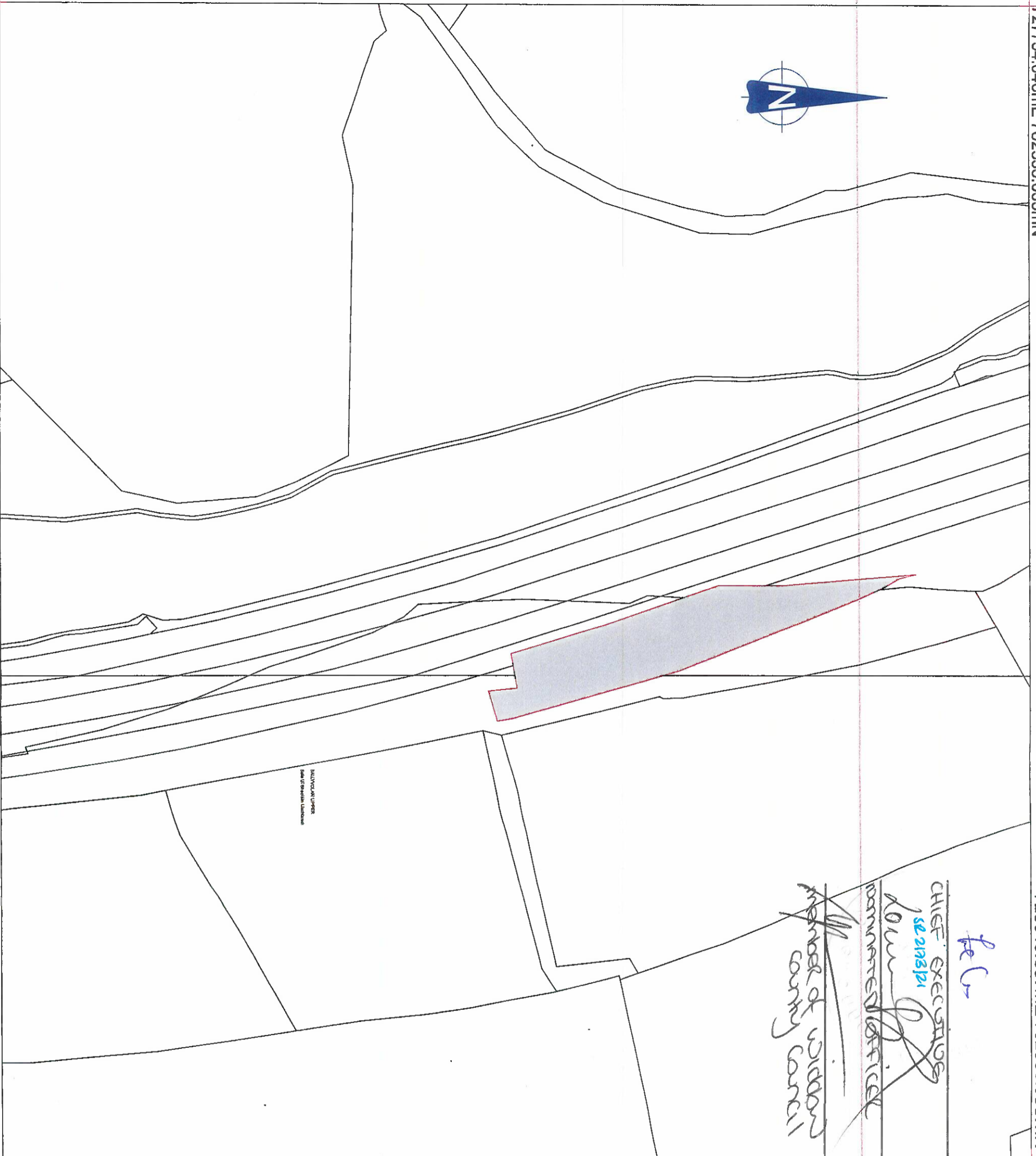

fe

CHIEF EXECUTIVE
 18/2/2021
 BALLYVOLIEN OFFICE

Member of Wicklow County Council

Licence No.
 2021/35/CCMA/WicklowCountyCouncil

PRAI Reference
S2021LR005995K.

Vesting Map

Map showing Vesting Area to be granted to : Wicklow County Council

Land referred to is contained in Plot 70c (WCC CPO Order No.2 1999) located in Ballyvolian Upper Td

Vesting Area outlined by Red Line and Shaded Grey
 Area of land to be Vested 0.1339Ha (0.3308 acre)

This map is computer generated from O.S. digital files plotted in accordance with Land Registry Regulations. L.R. Map 1,2,2a,&3 Appendix B3

Wicklow O.S. Plans:3848-C-3847-D

NO	INLS	DATE	DESCRIPTION

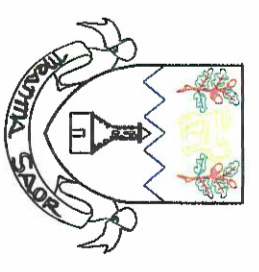

WICKLOW COUNTY COUNCIL

JOB : N11 NEWTOWN TO BALLYNABARNY ROAD IMPROVEMENT SCHEME

TITLE : LAND VESTING MAP PLOT 70c

SCALE:	Drawn	Checked
HORIZ = 1:1000		
VERT =	Date:	Apr. 2021

DRAWING NO:
N11/NBRIS/LVM Plot70c

727754.046mE 702296.035mN

727754.046mE 702553.035mN

728043.887mE 702553.035mN

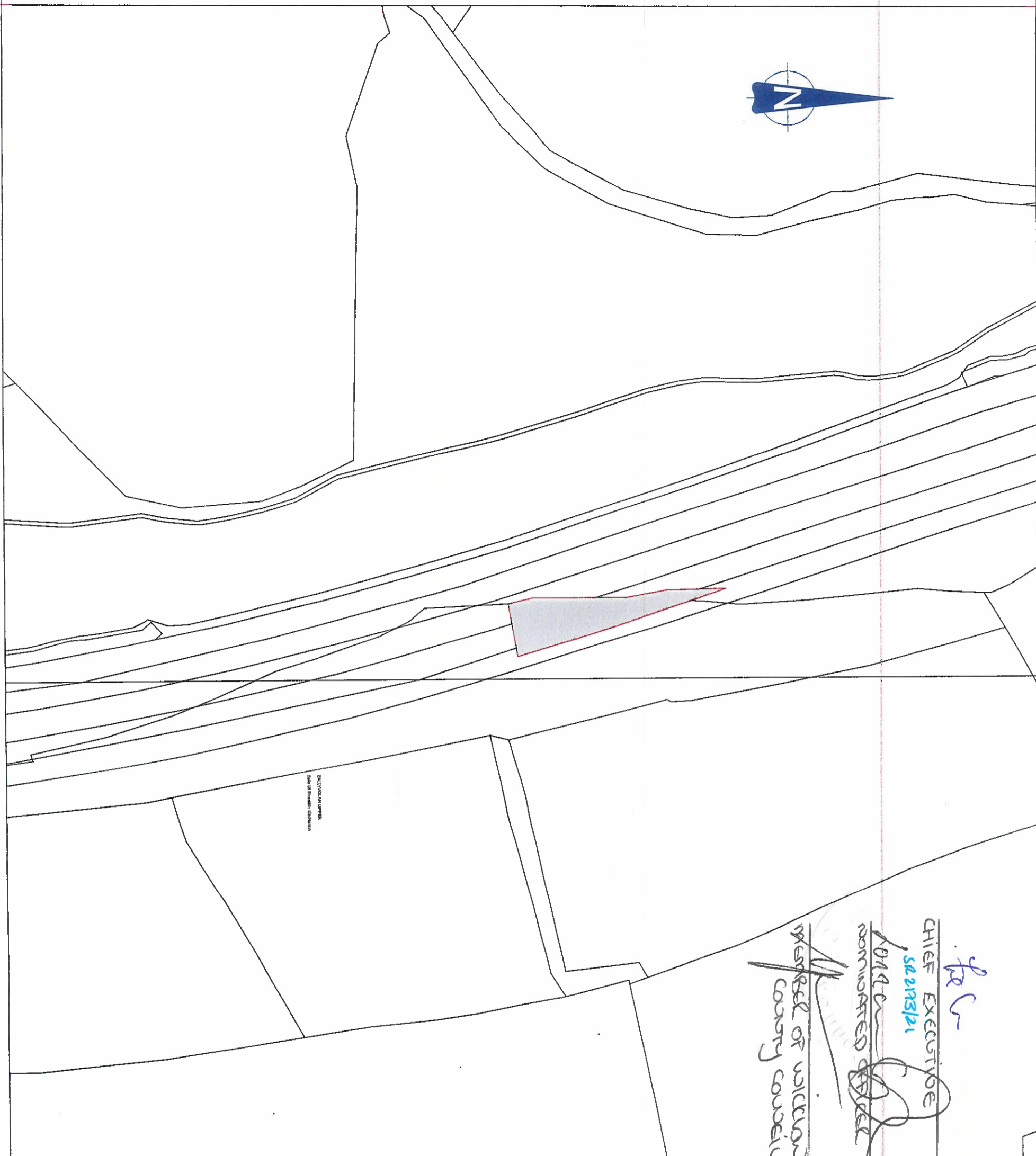

for
CHIEF EXECUTIVE
5/21/21
Approved
NOMINATED OFFICER
Wicklow
WEST OF WICKLOW
COUNTY COUNCIL

BALLYVOLAN UPPER
DATA BY BALLYVOLAN UPPER

Licence No.
2021/35/CCMA/WicklowCountyCouncil

PRAI Reference
S2021LR001391N.

Vesting Map
Map showing Vesting Area
to be granted to : Wicklow County Council

Land referred to is contained in Plot 70b
(WCC CPO Order No.2 1999)
located in Ballyvolan Upper & Kiltimon Td
Vesting Area outlined by Red Line and Shaded
Grey
Area of land to be Vested 0.0395Ha (0.0977 acre)

This map is computer
generated from O.S. digital files
plotted in accordance with
with Land Registry Regulations.
L.R. Map 1,2,2a,&3 Appendix B3
Wicklow O.S. Plans:3848-C 3847-D

NO	INLS	DATE	DESCRIPTION

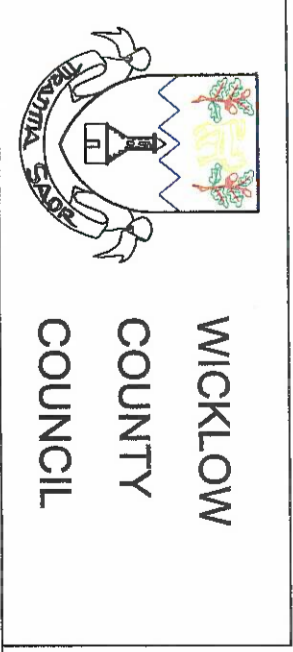

JOB :
N11 NEWTOWN TO BALLYNABARNY
ROAD IMPROVEMENT SCHEME
TITLE :
LAND VESTING MAP PLOT 70b

SCALE:
HORIZ = 1:1000
VERT =
Drawn
Checked
Date: Apr. 2021

DRAWING NO:
N11/NBRIS/LVM Plot70b

727754.046mE 702296.035mN

727707.815mE 702723.104mN

727997.656mE 702723.104mN



fe
 CHIEF EXECUTIVE
se 2183121
 DOMINION OFFICER
 OFFICE OF VESTING
 COUNTY COUNCIL

Licence No.
 2021/35/CCMA/WicklowCountyCouncil

PRAI Reference
S2021LR005688A.

Vesting Map
 Map showing Vesting Area
 to be granted to : Wicklow County Council

Land referred to is contained in Plot 3g
 (WCC CPO Order No.2 1999)
 located in Killimon Td

Vesting Area outlined by Red Line and Shaded
 Grey
 Area of land to be Vested 0.0078Ha (0.0194 acre)

This map is computer
 generated from O.S. digital files
 plotted in accordance with
 with Land Registry Regulations.
 L.R. Map 1,2,2a,&3 Appendix B3

Wicklow O.S. Plans:3848-C 3847-D

NO	INLS	DATE	DESCRIPTION

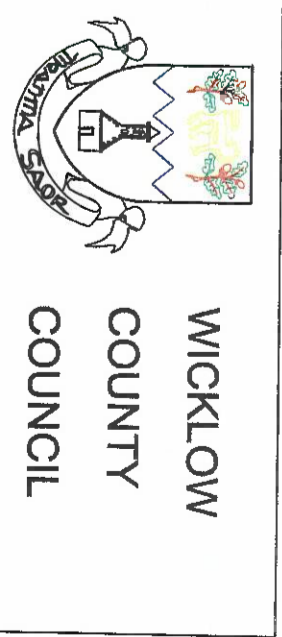

JOB :
 N11 NEWTOWN TO BALLYNABARNY
 ROAD IMPROVEMENT SCHEME

TITLE :
 LAND VESTING MAP PLOT 3g

SCALE:	Drawn	Checked
HORIZ = 1:1000		
VERT =	Date:	Apr. 2021

DRAWING NO:
N11/NBRIS/LVM Plot3g

727707.815mE 702466.104mN

727766.983mE 702359.007mN

728056.824mE 702359.007mN

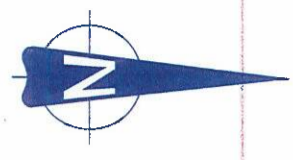

hgc
 CHIEF EXECUTIVE
SE 21/3/12
 NOMINATED OFFICER
 MEMBER OF WICKLOW COUNTY COUNCIL

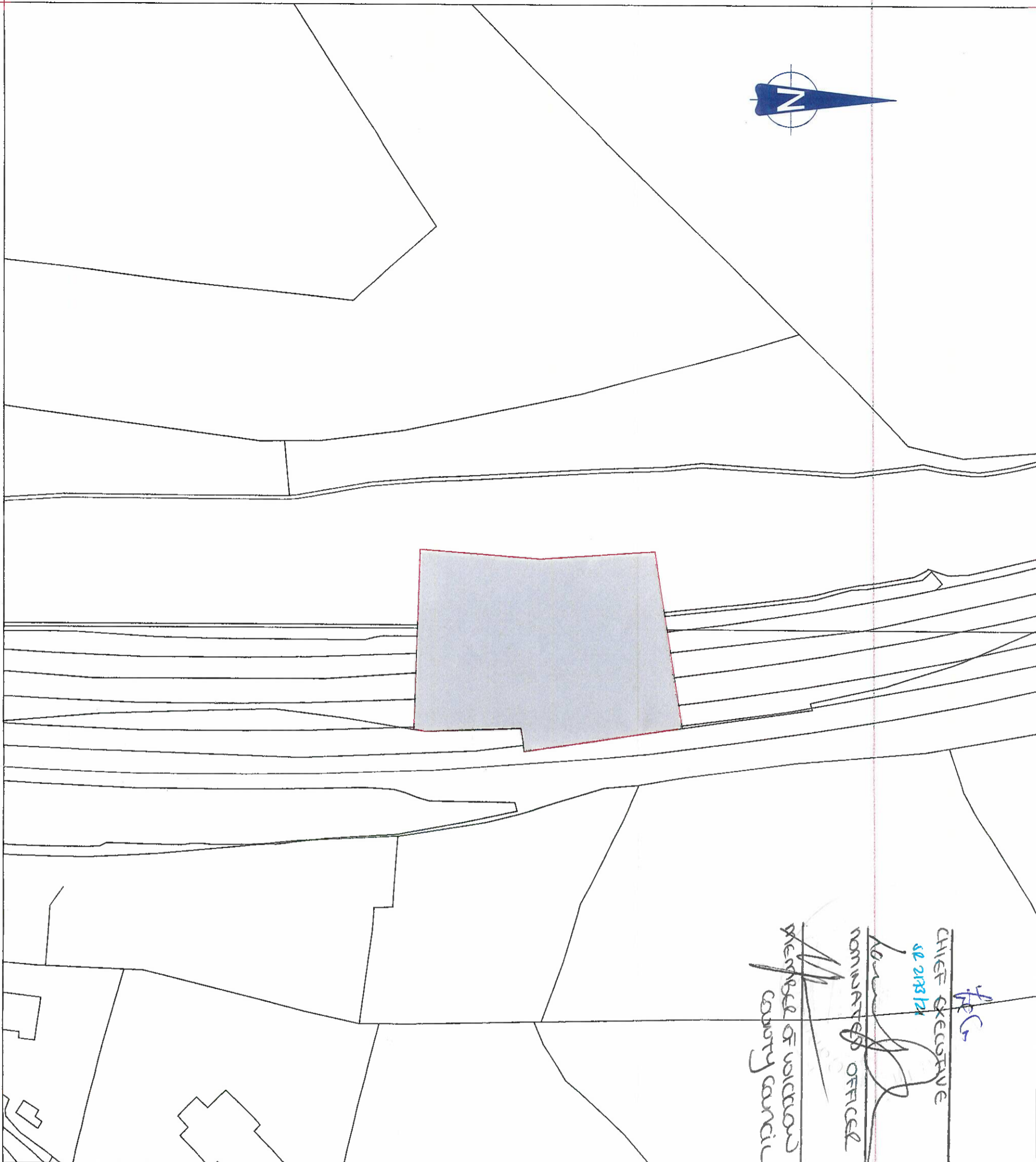

Licence No.
 2021/35/CCMA/WicklowCountyCouncil

PRAI Reference
S2021LR005684V

Vesting Map

Map showing Vesting Area to be granted to : Wicklow County Council

Land referred to is contained in Plot 67e (WCC CPO Order No.2 1999) located in Kiltimon TD

Vesting Area outlined by Red Line and Shaded Gray
 Area of land to be Vested 0.2845Ha (0.7029 acre)

This map is computer generated from O.S. digital files plotted in accordance with Land Registry Regulations. L.R. Map 1.2.2a, &3 Appendix B3

Wicklow O.S. Plans:3848-C.3847-D

NO	INLS	DATE	DESCRIPTION

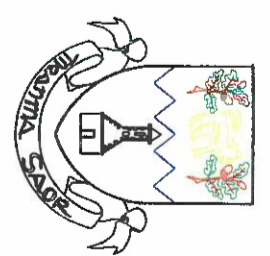

WICKLOW COUNTY COUNCIL

JOB : N11 NEWTOWN TO BALLYNABARNY ROAD IMPROVEMENT SCHEME

TITLE : LAND VESTING MAP PLOT 67e

SCALE: HORIZ = 1:1000 VERT =

Drawn	Checked

Date: Apr. 2021

DRAWING NO: N11/NBRIS/LVM Plot67e

727766.983mE 702102.007mN