

LANDSCAPE DESIGN AND PUBLIC REALM  
1:500

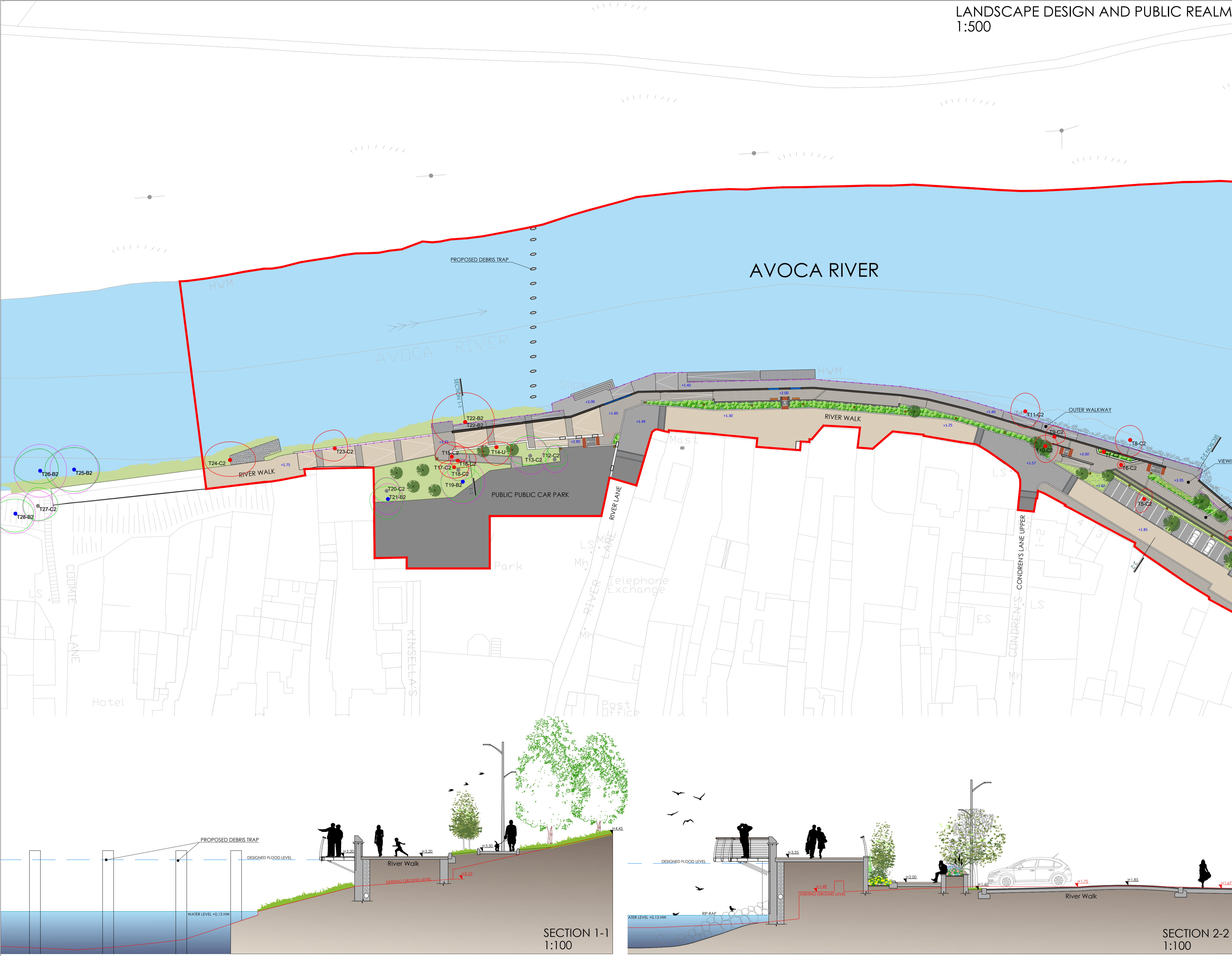

- LEGEND**
- PROPOSED SOFT LANDSCAPING**
- Existing Trees Retained including RPA
  - Existing Trees Removed
  - Existing Tree Groups Removed
  - Semi-mature Trees
  - Mix of Native Woodland Planting
  - Amenity Grass
  - Amenity Grass with Bulbs
  - Ornamental Grasses
  - Irish Native Species Rich Grass and Wildflower Mixture
  - Ornamental Shrubs and Perennials
  - Climbers
  - Roosting Platforms (Floating)
- PROPOSED HARD LANDSCAPING**
- Existing Paving/Surface Retained
  - Tarmac Road Finish
  - Buff Tarmac Finish
  - Concrete to Footpaths and Stairs
  - Tactile Paving
  - Stone Finished Paving Flags 400 x 200 mm - mixed colours
  - Stone Finished Paving Setts 200 x 100 mm - mixed colours
  - Paved Raised Table Junction with 200 x 100mm Setts
  - Boardwalk Decking
  - Hardcore Gravel
  - Rip-Rap
  - Proposed Flood Defence Wall
  - Proposed Glass Flood Panels
  - Proposed LED Public Street Lighting
  - Proposed LED Lighting under Handrail
  - Indicative Location for Seating
  - Existing Mooring Posts to be Relocated
  - Relocated Mooring Posts
  - Proposed Landscape Levels (All Levels OD Malin)
  - Planning Boundary

- PLANTING SCHEDULE**
- PROPOSED RIVER WALK AND PUBLIC PLAZA TREES SPECIES**  
(16-18 cm STD and 20-25 cm STD)
- Acer platanoides 'Columnare' (Norway Maple)
  - Betula pendula (Birch)
  - Crataegus laevigata 'Paul's Scarlet' (Hawthorn)
  - Pinus sylvestris (Scott's Pine)
  - Prunus avium 'Plena' (Double flowered Wild Cherry)
- PROPOSED SOUTH QUAY TREES SPECIES**  
(16-18 cm STD and 20-25 cm STD)
- Acer platanoides 'Columnare' (Norway Maple)
  - Ulmus 'Lobel' (Elm DED resistant)
  - Prunus avium 'Plena' (Wild Cherry)
- PROPOSED ORNAMENTAL SHRUBS SPECIES**  
(1-2L Container grown, planted at 3-5/sqm)
- Aucuba japonica 'Rozannie' (Japanese Laurel)
  - Caryopteris x clandonensis 'Kew Blue' (Bluebeard)
  - Choysa x dewilliana 'Aztec Pearl' (Mexican Orange)
  - Elaeagnus x ebbingei 'Gilt Edge' (Oleaster)
  - Hypericum 'Hidcole' (St. John's Wort)
  - Fuchsia riccartonii (Red Fuchsia)
  - Lavandula angustifolia 'Hidcole' (Lavender)
  - Lavandula stoechas (Lavender)
  - Salvia lavandulifolia (Spanish Sage)
  - Sarcococca hookeriana var. humilis (Sweetbox)
  - Rosa rugosa 'Agnes' (Shrub Rose)
  - Rosmarinus officinalis 'Prostratus' (Rosemary)
- PROPOSED ORNAMENTAL GRASSES WITH POLLINATOR FRIENDLY FLOWERING PERENNIALS**  
(1-2L Container grown, planted at 5-7/sqm)
- Carex comans 'Frosted Gull' (New Zealand Hair Sage)
  - Carex morrowii 'Evergold' (Evergold Sedge)
  - Hakonechloa macra (Japanese Forest Grass)
  - Helenium 'Moorheim Beauty' (Sneezeweed)
  - Rudbeckia 'Goldsturm' (Black-Eyed Susan)
  - Sedum spectabile 'Autumn Joy'
  - Salvia nemorosa 'Caradonna' (Salvia)
  - Stipa tenuifolium 'Pony Tails' (Mexican Feather Grass)
  - Miscanthus 'Morning Light' (Chinese Silver Grass)
  - Verbena bonariensis (Brazilian Vervain)
- PROPOSED CLIMBERS**  
(2L Container grown, planted at 2/lin.m)
- Jasminum officinale (Common Jasmine)
  - Lonicera periclymenum (Honeysuckle)
  - Parthenocissus tricuspidata (Boston Ivy)
- PROPOSED NATIVE WOODLAND PLANTING AREA 1**  
Transplants (60-90cm), Bareroot
- 40% Alnus glutinosa (Black Alder)
  - 40% Salix aurita, Salix cinerea oleifolia, Salix caprea, Salix petrandra (Willow)
  - 20% Betula pubescens (Downy Birch)
- PROPOSED NATIVE WOODLAND PLANTING AREA 2**  
Transplants (60-90cm), Bareroot
- 20% Alnus glutinosa (Black Alder)
  - 20% Betula pubescens (Downy Birch)
  - 20% Salix spp. (Willow)
  - 15% Prunus spinosa (Blackthorn)
  - 15% Crataegus monogyna (Hawthorn)
  - 10% Viburnum opulus (Guelder Rose)
- IRISH NATIVE SPECIES RICH GRASS AND SEASIDE WILDFLOWER MIXTURE**
- 80% Grass Seed Mixtures
  - 20% Native Origin Irish Wildflower Seed Mixtures

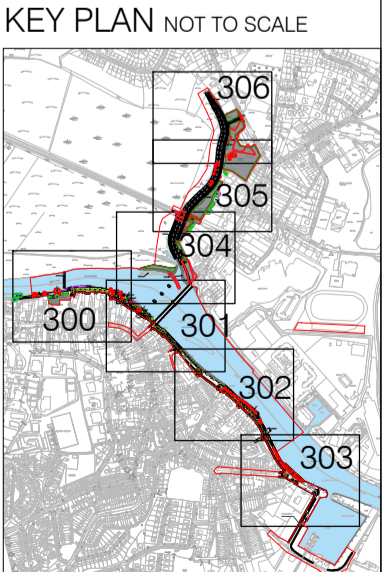

Rev	Date	Drawn	Checked	Description	Notes
02	12.04.2021	JV	JK	Issue For Information	
01	09.03.2021	JV	JK	Issue For Information	

**SECTION 1-1**  
1:100

**SECTION 2-2**  
1:100

Copyright © All Rights Reserved.

This work is copyright and cannot be reproduced or copied in any form without the written permission of the designer.

DO NOT SCALE FROM THIS DRAWING. WORK ONLY FROM FIGURED DIMENSIONS.

THIS DRAWING TO BE READ IN CONJUNCTION WITH RELEVANT CONSULTANT'S DRAWINGS.

Project: Arklow Flood Relief Scheme

Dwg: Landscape Design and Public Realm

Scales: 1:500 / 1:100 (A1)

Status: For Planning

Date: 12.04.2021

Drawn: JV

Checked: JK

Passed

Project No: 6545

Drawing No: 300

Rev: 02

**BSM**

Est. 1968