

Land Registry

County Wicklow

Folio 10772

LAND AROUND
BERRYFIELD HOUSE
(A98R2P7)

Part 2 - Ownership

Title ABSOLUTE

No. The devolution of the property is subject to the provisions of Part II of the Succession Act, 1965

1

2

3

4



County Wicklow Residential Zoned Land Tax (RZLT)

Submission Template

A: Details of person / representative / agent making submission

Name	[REDACTED]
Address	[REDACTED] <small>(include Eircode please)</small>
Phone No.	[REDACTED]
Email Address	[REDACTED]

If you are the landowner of the lands that are the subject of this submission, or making the submission on behalf of the landowner, please complete Part (B) of this form.

If you are not the landowner of the lands that are the subject of this submission or making the submission on behalf of the landowner, (i.e. you are a 'third party') please complete Part (C) of this form.

Please be advised that personal information will be redacted before publishing.

B: Landowner Submission

Town	BRAY
Landowner name	[REDACTED]
Landowner address	[REDACTED] <small>(include Eircode if known)</small>
Landowner phone	[REDACTED]
Landowner email	[REDACTED]
Address of site	BERRYFIELD FASSAROE BRAY, Co. Wicklow A98R2P7 <small>(include Eircode if known)</small>
Site description	<small>(if address is unclear)</small>
Site Area	8 ACRES

Maps / information to accompany submission	Check
Have you included the required Ordnance Survey map showing the lands at an appropriate scale i.e. 1:1000 in urban areas or 1:500 in rural area, clearly identifying the map in question?	<input checked="" type="checkbox"/>
Have you included proof of ownership?	<input checked="" type="checkbox"/>

Are you:	Check
Challenging the inclusion of certain lands on the map?	<input checked="" type="checkbox"/>
Challenging the date that lands are considered to be 'in scope'?	<input type="checkbox"/>
Requesting a change in zoning?	<input type="checkbox"/>
Identifying additional lands that you believe should be shown on the maps?	<input type="checkbox"/>

Grounds for your submission (please see advice at end of this document) **THE LAND IS NOT SERVICED. THERE IS GROSSLY INADEQUATE ROAD INFRASTRUCTURE, NO FOOTPATHS, NO FOUL SEWERAGE, NO SURFACE WATER DRAINAGE, NO PUBLIC LIGHTING, NO BROADBAND, NO WATER SUPPLY.**

THE LAND IS NOT VACANT AND IS USED FOR AGRICULTURAL PURPOSES
BERRYFIELD HOUSE (A98R2P7) 1 ACRE AND BERRYFIELD LODGE (A98VK06) 1 ACRE ARE SUBJECT TO PROPERTY TAX.

EXTRACT FROM
O.S. Wicklow
SHEET
3-16

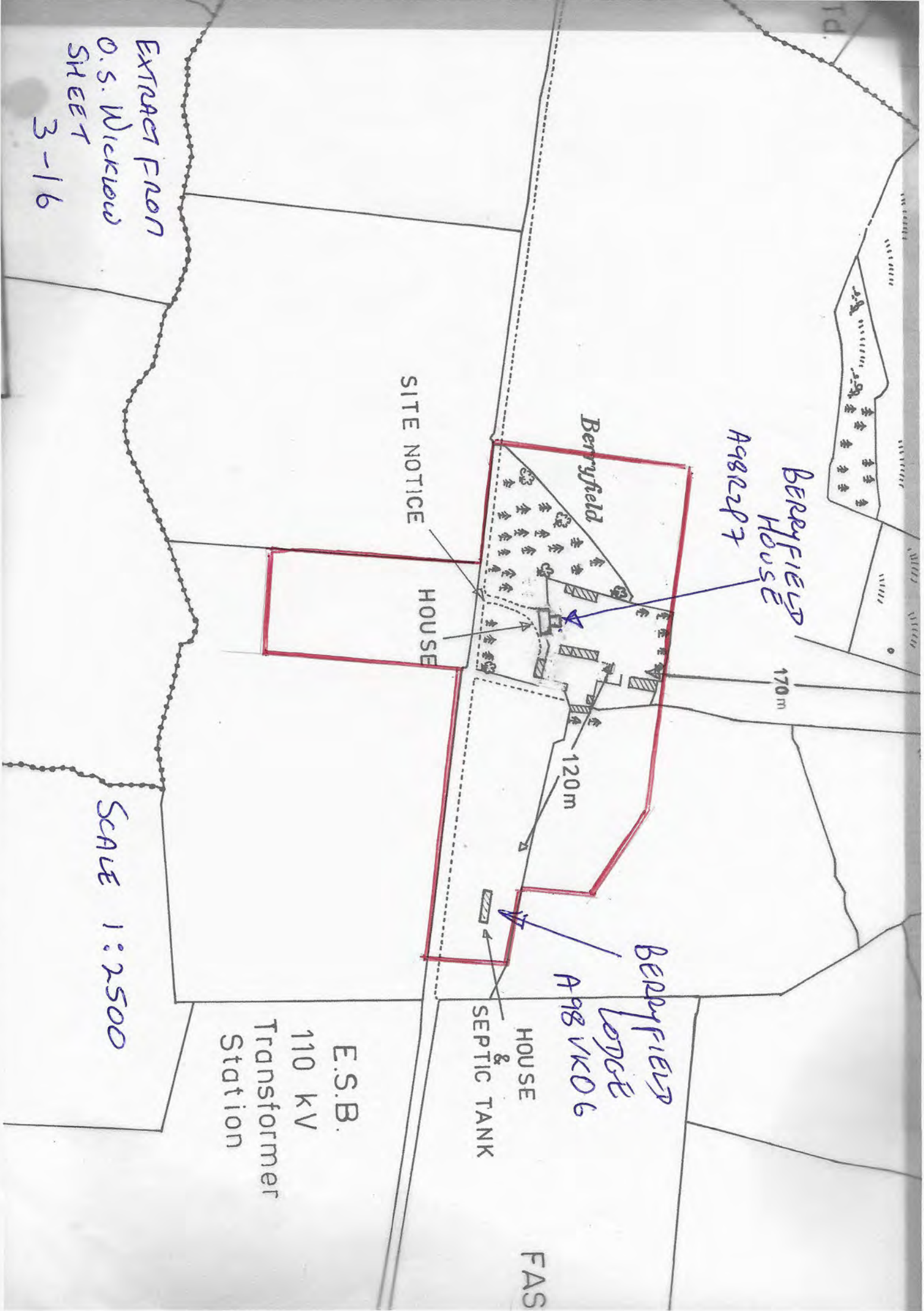

E.S.B.
110 kV
Transformer
Station

SCALE 1:2500

HOUSE
&
SEPTIC TANK

F.A.S.

SITE NOTICE

HOUSE

BERRYFIELD
LODGE
A98VK06

BERRYFIELD
HOUSE
A982297

170m

120m

ID.

1000 134 B34



Creation Date: 10 May 2022 11:43:31

**The Property
Registration Authority
An tÚdarás
Clárúcháin Maoinne**



Official Property Registration Map

This map should be read in conjunction with the folio.

Registry maps are based on OSI topographic mapping. Where registry maps are printed at a scale that is larger than the OSI published scale accuracy is limited to that of the original OSI Map Scale.

For details of the terms of use, and limitations as to scale, accuracy and other conditions relating to Land Registry Maps, see www.pra.ie.

This map incorporates Ordnance Survey Ireland (OSI) mapping data under a licence from OSI. Copyright © OSI and Government of Ireland.

- (indicating line of parcel(s) edged) Freehold
- Leasehold
- Subleasehold
- 'S' Register

(see Section 8(b)(ii) of Registration of Title Act 1964 and Rule 224 & 225 Land Registration Rules 1972 - 2010).

- Burdens** (may not all be represented on map)
- Right of Way / Wayleave
 - Turbary
 - Pipeline
 - Well
 - Pump
 - Septic Tank
 - Soak Pit

A full list of burdens and their symbology can be found at: www.landireg.ie

The registry operates a non-conclusive boundary system. The Registry Map identifies properties not boundaries meaning neither the description of land in a register nor its identification by reference to a registry map is conclusive as to the boundaries or extent.

(see Section 85 of the Registration of Title Act, 1964). As inserted by Section 62 of the Registration of Deed and Title Act 2006.



Land Registry

County Wicklow

Folio 13483F

BERRYFIELD
HOUSE
A98R2P7

Part 2 - Ownership

Title ABSOLUTE

No.	The devolution of the property is subject to the provisions of Part II of the Succession Act, 1965
1	
2	
3	

Land Registry

County Wicklow

Folio 4238

BERRYFIELD LODGE
A98VK 06

Part 2 - Ownership

Title ABSOLUTE

No. The devolution of the property is subject to the provisions of Part II of the Succession Act, 1965

1

2

3

4

5