

- NOTES**
1. THIS DRAWING IS TO BE READ IN CONJUNCTION WITH ALL OTHER RELEVANT ENGINEERING DRAWINGS. ANY DISCREPANCIES, ERRORS OR OMISSIONS TO BE BROUGHT TO THE ATTENTION OF THE EMPLOYER.
 2. ALL DIMENSIONS TO BE CHECKED BY THE CONTRACTOR ON SITE PRIOR TO COMMENCEMENT OF WORKS.
 3. EMPLOYER'S REPRESENTATIVE TO BE INFORMED BY THE CONTRACTOR OF ANY DISCREPANCIES PRIOR TO THE COMMENCEMENT OF WORKS ON SITE.
 4. DIMENSIONS OF ALL BOUNDARIES AND ADJOINING ROADS TO BE CHECKED ON SITE PRIOR TO COMMENCEMENT OF WORKS.
 5. DO NOT SCALE. ALL MEASUREMENTS AND COORDINATES TO BE CHECKED ON SITE.
 6. EXISTING FENCE LINES ARE INDICATIVE AND ARE TO BE CONFIRMED ON SITE. EXISTING FENCING IS TO BE REVIEWED ON SITE AND REPLACED WHERE REQUIRED.
 7. EMERGENCY ACCESS POINTS ARE TO BE CLOSED OFF WITH DEMOUNTABLE BOLLARDS. KEYS TO BE HANDED OVER TO THE OVERSEEING ORGANISATION.
 8. EGREENWAY DRAINAGE IS TO BE OVER THE EDGE DRAINAGE

ISSUE/REVISION

I/R	DATE	DESCRIPTION
1	DEC 2023	ABP RFI UPDATE
0	SEPT 2023	ISSUED FOR PLANNING

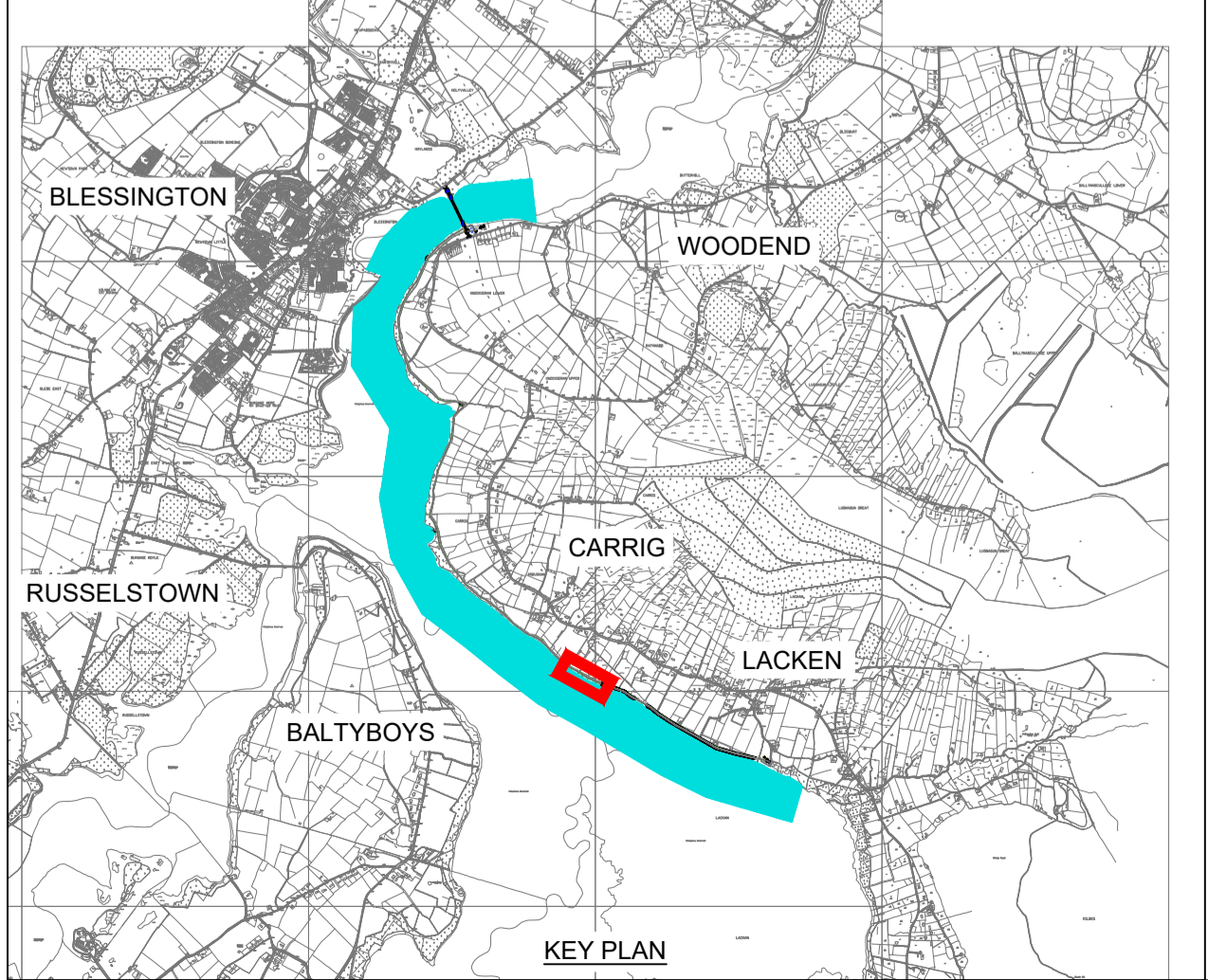
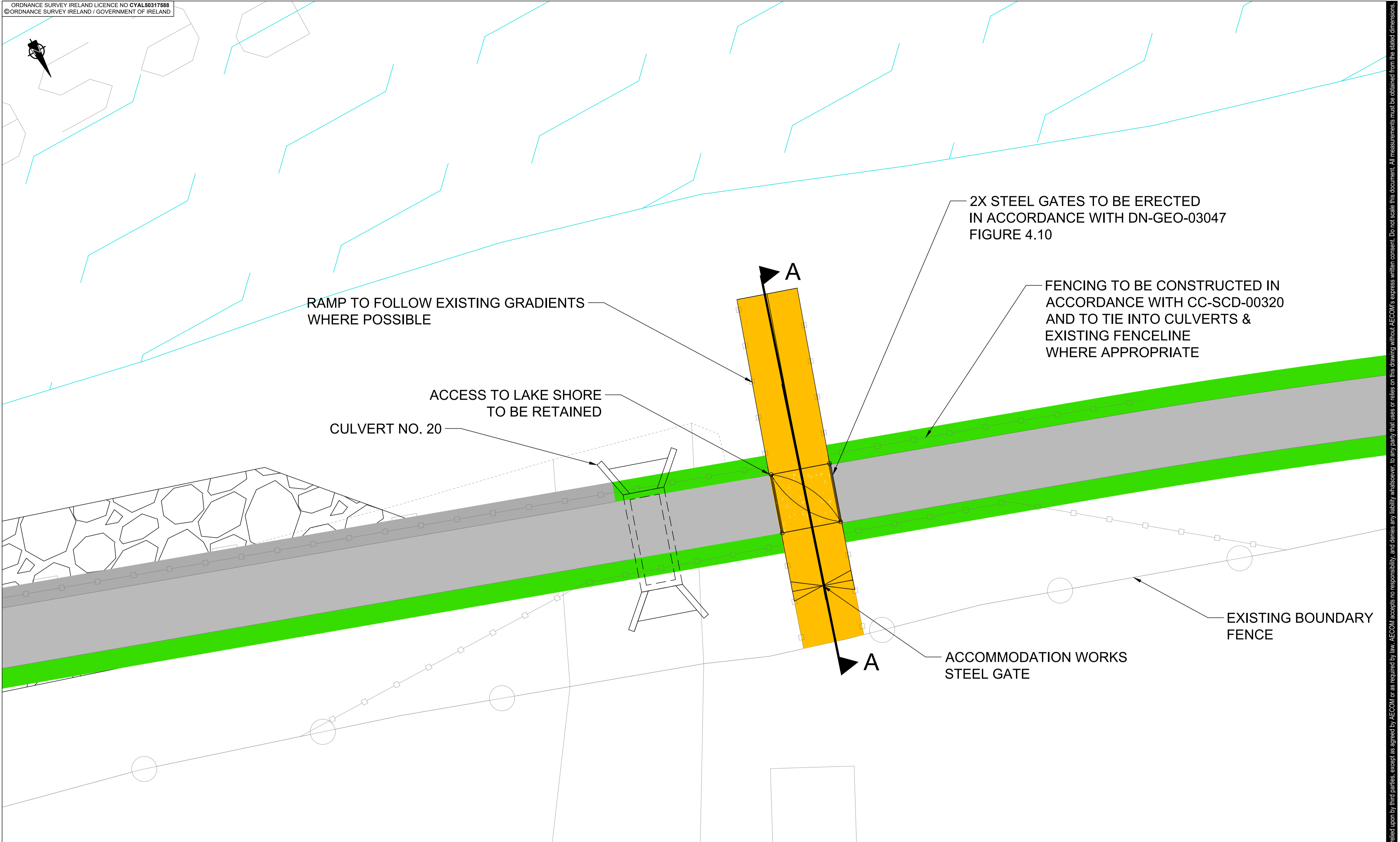

- KEY:**
- PROPOSED GREENWAY
 - PROPOSED RIGHT OF WAY CROSSING
 - PROPOSED GRASS VERGE
 - PROPOSED EARTHWORKS FILL
 - PROPOSED EARTHWORKS CUT
 - BLESSINGTON LAKE
 - WATER CROSSING STRUCTURE
 - PROPOSED ROCK ARMOUR
 - EXISTING FENCE LINE
 - PROPOSED FENCE LINE

